

CONCRETE SPRAYER LIGHTING

For Models : All Concrete Sprayer Equipment



LED | LIGHTING CATALOG



ENGINEERED LIGHTING SOLUTIONS

Vision X lighting fixtures are not merely lighting systems, they are engineered lighting solutions. They provide increased efficiency, increased safety, decreased environmental impact, and decreased costs. Vision X LED lights offer a large increase in energy efficiency over older technologies while also increasing the safety and productivity of the working environment by outputting 80% more light than the fixtures used previously.



SOLUTION PROCESS

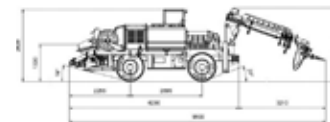

2D BLUEPRINT

Vision X Lighting begins each project with a customer provided list of machines to be retrofitted, then gathers the technical information for those machines.



3D MODEL

A 3D model is built to the customer's specifications, then carried over into the rendering.

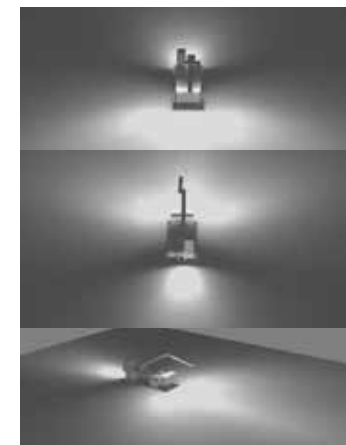

SIMULATION RENDER

A simulation rendering ensures the final product will meet the customer's lighting requirements.

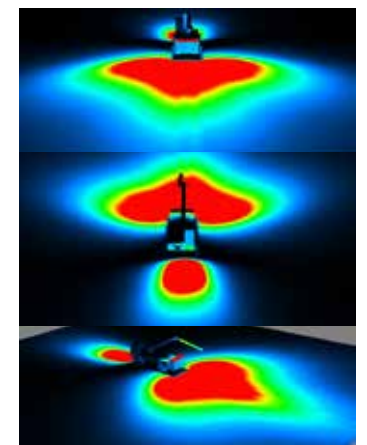

SOLUTION

Vision X Lighting creates a complete breakdown of the customer's specific needs to meet their safety requirements.



CONCRETE SPRAYER FITOUT GUIDE

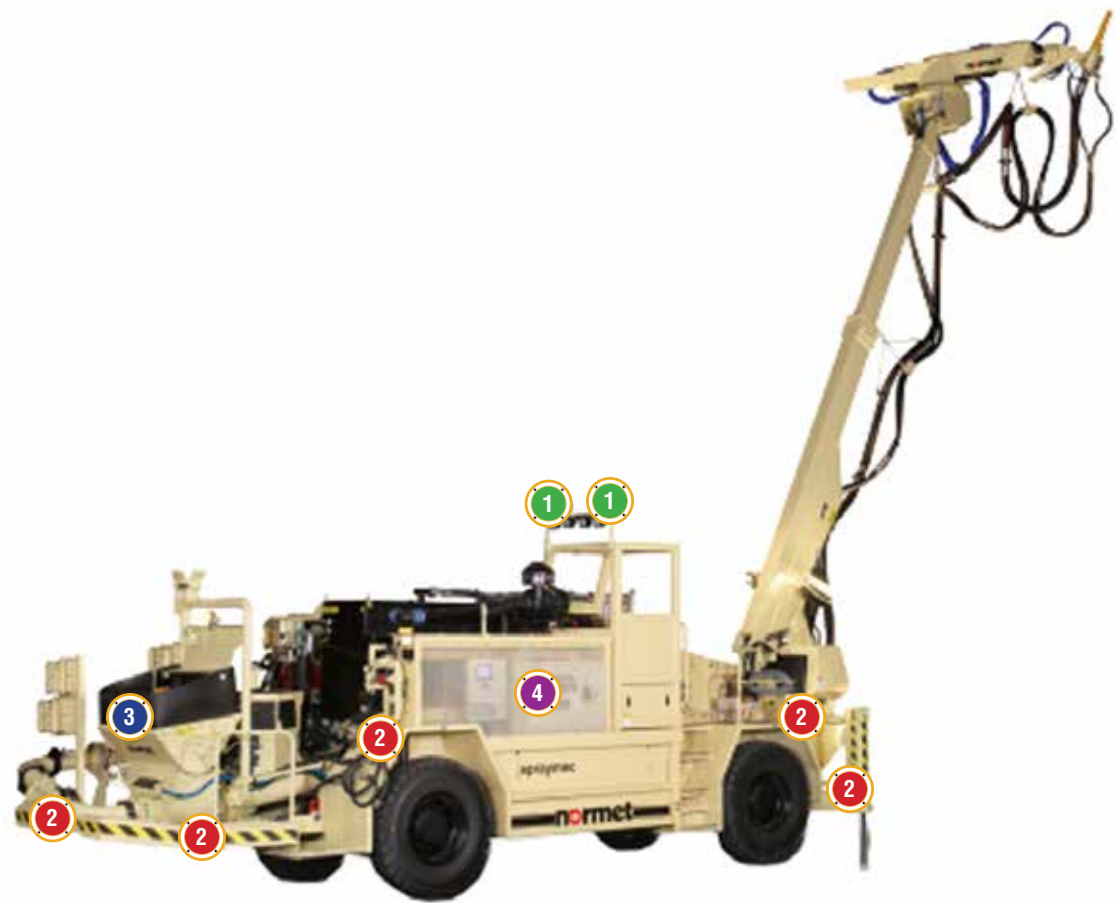
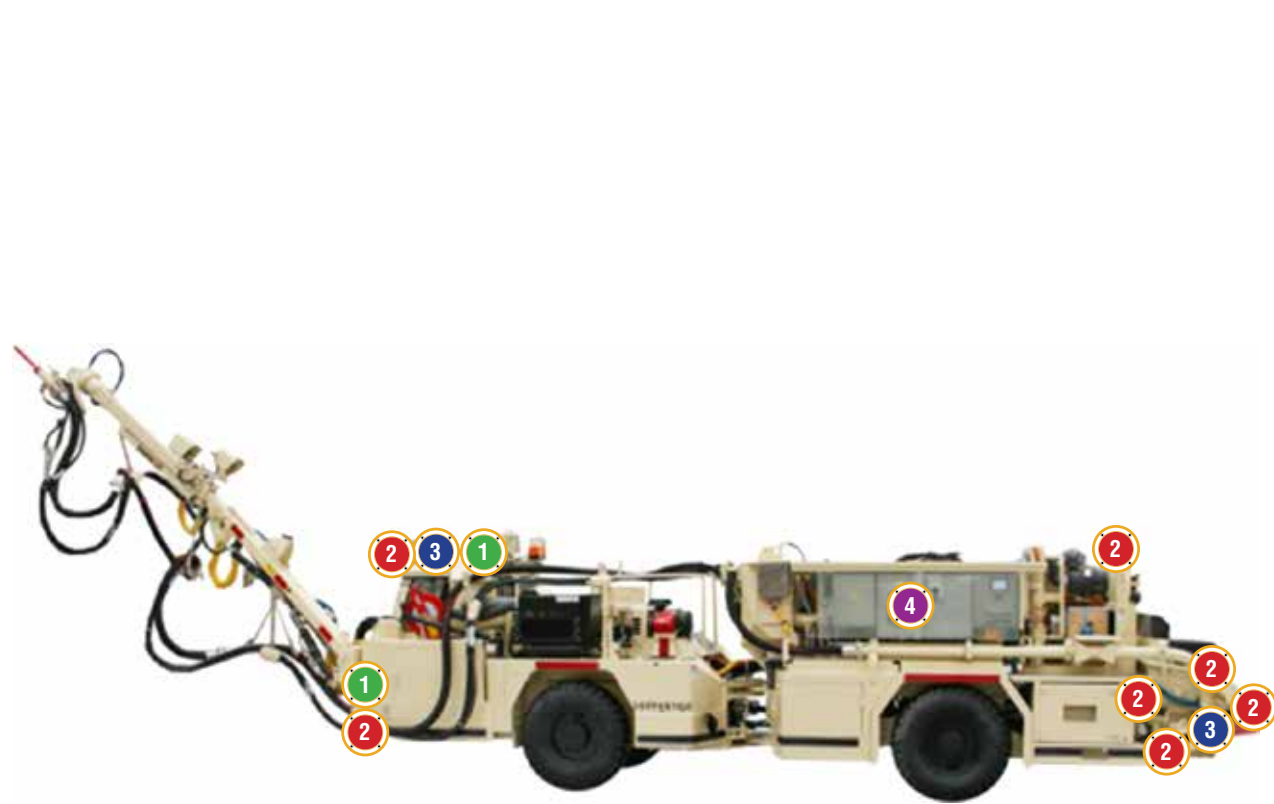

1 BT-9 ELLIPTICAL



FORWARD LIGHTING
BT-SERIES WORK LIGHT

Number of Fixtures : 4
Location : 2x Front Facing,
2x Top Rear Corner of Cabin
Beam Pattern : 30/60° Elliptical
Part # : BHB07093065

2 BT-9 FLOOD



WORK AREA LIGHTING
BT-SERIES WORK LIGHT

Number of Fixtures : 9
Location : 2x Front Facing, 2x Lower Forward/Side Facing,
2x Rear Facing, 2x Lower Rear/Side Facing,
2x Top Forward/Side Facing
Beam Pattern : 60° Flood
Part # : BHB070960

3 DRIFT STROBE



ACCESSORY LIGHTING
DRIFT STROBE

Number of Fixtures : 2
Location : Front, Back
Colors Available : Green, Red, Blue, Amber
Part # : XIL-LP625.G.2HZ (Green)

4 ID BOARD



ACCESSORY LIGHTING
2&3 DIGIT LED ID BOARDS

Number of Fixtures : 2
Location : Side Panel
Colors Available : Green, Red,
Amber in 2&3 Digits
Part # : MIL-ID02R (Red 2Digit)



DRIVING / WORK AREA LIGHTING

Product Information

Project Name:
Date:
Type:

DESCRIPTION

The BT Heavy Industrial Series offers outstanding light output in a functional design utilizing a stainless steel forward rake trunnion bracket with integrated aiming markings. The aiming system with 3D fit-outs ensures the correct light for any environment, as well as, increases safety by controlling stray light from reaching oncoming operators' view.

- Features and Benefits:
- Compact and Durable Die-Cast Housing Construction
 - Reverse Polarity Protection
 - Multiple Beam Pattern Options
 - 700 Watt Halogen Equivalent

SPECIFICATIONS

MECHANICAL

Fixture Weight:	4.98 lbs (2.26kg)
Shipping Weight:	6.05 lbs (2.74kg)
Mounting:	Single Bolt M10

TECHNICAL

LED:	XP-L(CREE)
Raw Lumens:	7,200 lm
Effective Lumens:	5,734 lm
Wattage:	63W
Wattage Per LED:	7W
Amp Draw:	5.25A @ 12VDC 2.63A @ 24VDC
Color Temperature:	5,700 Kelvin
Operating Voltage:	11-60V DC
Operating Temperature:	-40°C ~ 85°C
Lifespan:	50,000 hrs
Polarity:	Reverse Polarity Protection
Connector:	2 Pin Deutsch

CONSTRUCTION

Housing:	Die-Cast 6061 Aluminum
Finish:	Gloss Black & Gloss Yellow Bezel
Lens:	Polycarbonate
Bracket Material:	304 Stainless Steel

RATINGS

EMC Emission:	(CISPR 25) Edition 3.0 (2008-03) Class 3
Ingress Protection:	IP-68, IP69k
Vibration Rating:	60 Grms
Warranty:	3 Years



PART #:	BEAM PATTERN
1 BHB07093065	Elliptical 30/65°
2 BHB070960	Flood 60°

2D DRAWING:

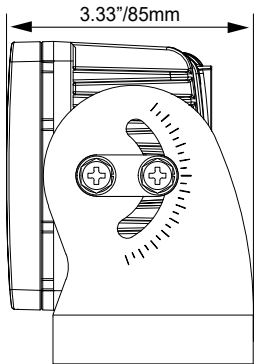
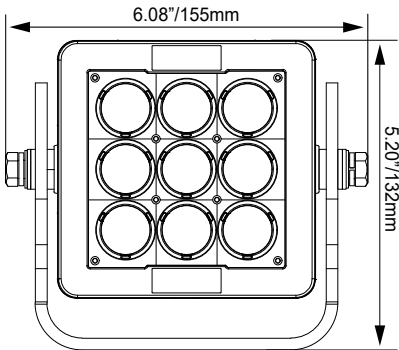

ACCESSORY LIGHTING

Product Information

Project Name:
Date:
Type:

DESCRIPTION

The Drift Strobe Series is designed with enhanced visibility down narrow passageways. Necessary for placement on both the front and rear of the vehicle, the drift strobe is built with a focused beam to aim at the top of the drift notifying oncoming traffic up to 200 feet sooner than a conventional strobe without blinding either operator.

- Features and Benefits:
- Durable Die-Cast Housing Construction
 - Four Colored LED Options
 - Reverse Polarity Protection
 - 15.6 Grms Vibration Rating

SPECIFICATIONS

Fixture Weight:	2.62 lbs (1.19kg)
Wattage	9W
Amp Draw	0.6A @12V 0.3A@24V
Operating Voltage:	9-32V DC
Ingress Protection:	IP-68
Mounting:	Dual M6 Stud Mount

DESCRIPTION

The Vision X ID Number Board allows personnel to quickly identify vehicles in any weather condition. Available in 2-Digit or 3-Digit configurations, these LED ID Boards can be changed as often as needed, and are engineered to run 24/7. Installing the Vision X ID Number Board means vehicles won't require numbers to be painted and can be quickly changed, reducing downtime during crucial timeframes.

- Features and Benefits:
- Numerical LEDs Controlled Via Magnetic Sensor
 - 195 LEDs Per Number
 - Red, Green, Blue, Amber LEDs Available
 - Auto Dim / Bright for Day and Night time Operation

SPECIFICATIONS

Fixture Weight:	2Digit: 21 lbs (9.53kg) 3Digit: 27 lbs (12.25kg)
Wattage	2Digit : 78W 3Digit : 117W
Amp Draw	2Digit : 6.5A@12V 3.25A@24V 3Digit : 9.75A@12V 4.88A@24V
Vibration Rating	21.2 Grms
Operating Voltage:	12-36V DC
Ingress Protection:	IP-68/ IP69K
Mounting:	Modular Mounting Brackets



PART #:	COLOR
3 XIL-LP625.A.2HZ	Amber
XIL-LP625.B.2HZ	Blue
XIL-LP625.G.2HZ	Green
XIL-LP625.R.2HZ	Red

2D DRAWING:

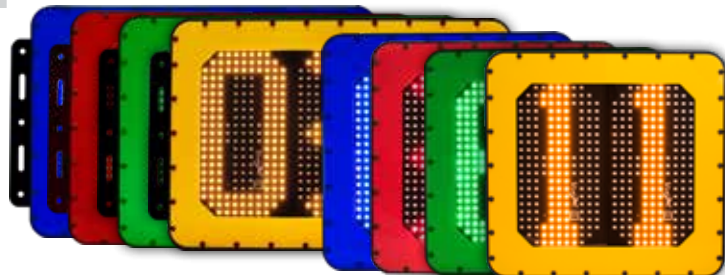
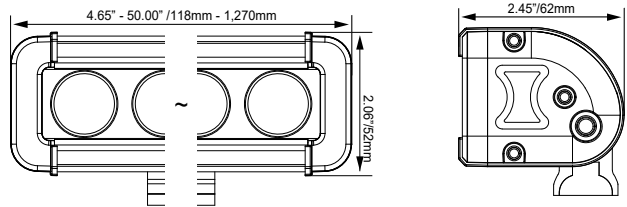

PART #:	#DIGITS / COLOR
MIL-ID02R	2 Red
4 MIL-ID02G	2 Green
MIL-ID02B	2 Blue
MIL-ID02A	2 Amber
MIL-ID03R	3 Red
MIL-ID03G	3 Green
MIL-ID03B	3 Blue
MIL-ID03A	3 Amber

2D DRAWING:

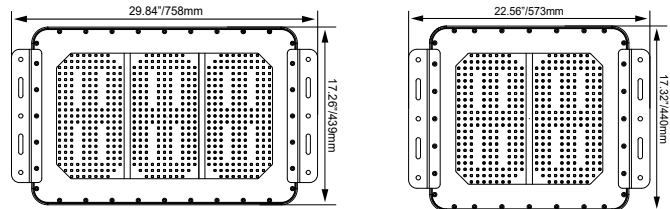



VISION X USA
1601 Boundary Blvd
Auburn WA 98001
United States of America
P: 253-218-2900
www.vxindustrial.com



VISION X ASIA
23-7 Dongtansandan
9-gil Dongtan-myeon Hwaseong-si
Gyeonggi-do 18487, Korea
P: 82-32-515-4814
www.visionxlighting.com